

**LAST SUITE AVAILABLE!**



Marlon Lynn  
Architect, PA  
A A 2 6 0 0 1 4 7 7

## MARYOMA PLAZA

LAKELAND, FLORIDA

**5615 South Florida Avenue,  
Lakeland, Florida 33813**

- New South Lakeland Retail Plaza.
- Last suite available 2,400 SF (30' x 80') next to Burgerim Restaurant.
- Median Cut on South Florida Avenue.
- High Traffic - High demographics area.
- Occupancy: Fall 2018



### DEMOGRAPHICS

2016 DATA	1 MILE	3 MILE	5 MILE
<i>Population</i>	4,026	46,363	97,092
<i># Family Households</i>	1,202	12,989	26,485
<i>Average HH Income</i>	94,935	64,253	60,279



**Commercial Real Estate Services From Local to Global Since 1998**

For further information regarding this property, please contact:

**Maria Mahoney**, FL, Real Estate Broker

3825 South Florida Ave. Suite 5 Lakeland, FL 33813

**Phone: 863-619-6740 • Fax: 863-619-6750**

email: maria@mahoneygroupinc.com • www.mahoneygroupinc.com





## ◁ **Maryoma Plaza** ▷

***LAST AVAILABLE SUITE!***

***NEW SOUTH LAKELAND RETAIL PLAZA***

Property Address:	5615 South Florida Avenue, Lakeland, FL 33813
Property Location:	On West side of South Florida Avenue (Lakeland's main North/South thoroughfare). South of Schoolhouse Road and Fitzgerald Road, halfway between Lake Miriam Drive and Shepherd Road.
Size Land:	2.29 acres – 330' frontage on South Florida Avenue
Total Building Size:	14,400 ± SF - CB construction building, fully sprinklered.
AVAILABLE SPACE:	Last suite available 2,400 SF (30' x 80'). Shared driveway entrance – immediate access to median cut on S. Florida Avenue for Northbound access. Signage opportunity with tenants' channel lettering on building facade and pylon sign.
Lease Rate:	\$35.00/SF plus applicable sales tax, NNN lease with CAM to be determined.
Delivery of Premises:	Fall 2018 – Space will be delivered in a Vanilla Shell condition.
Traffic Count:	40,500 AADT.
Land Use/Zoning:	C-2 Commercial Retail – Unincorporated Polk County
Parking:	92 parking spaces – non-exclusive basis
Comments:	Brand new retail plaza which will be the new site of Lakeland's first Burgerim restaurant. Superior location, prime visibility and access in South Lakeland's high demographics' area.
Contact:	Maria Mahoney Licensed Florida R.E. Broker (863) 619-6740

# Maryoma Plaza

5615 South Florida Avenue, Lakeland, FL 33813

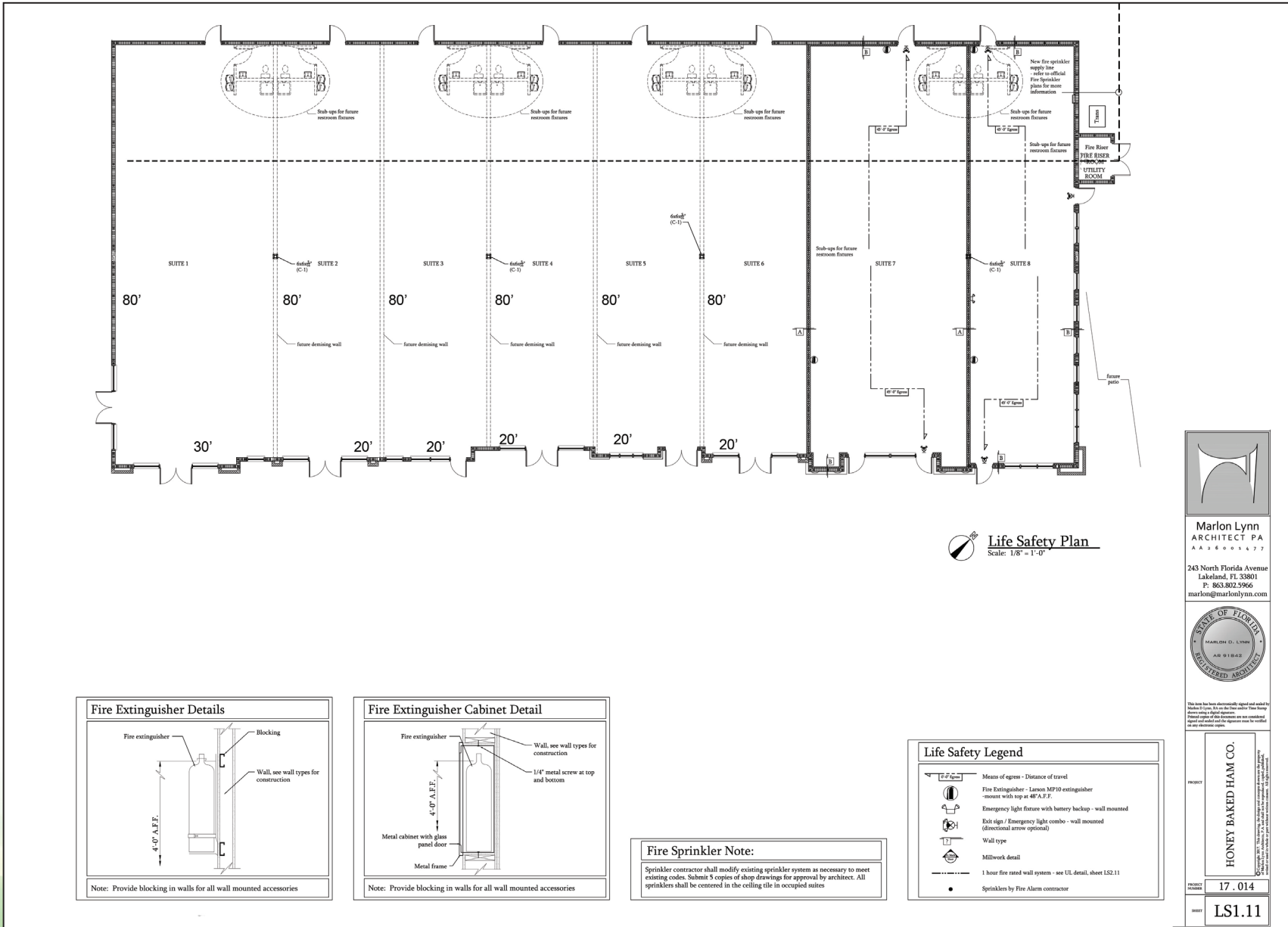

**Marlon Lynn ARCHITECT PA**  
 A A A 6 0 0 4 7 7

243 North Florida Avenue  
 Lakeland, FL 33801  
 P: 883.802.2966  
 marlons@marlonlynn.com

STATE OF FLORIDA  
 MARLON D. LYNN  
 A.B. 91842  
 REGISTERED ARCHITECT

**HONEY BAKED HAM CO.**

PROJECT NUMBER **17\_014**  
 SHEET **LS1.11**





# Maryoma Plaza

5615 South Florida Avenue, Lakeland, FL 33813



DISCLAIMER: Information contained herein is from sources deemed reliable, but not verified and no warranty is made as to the accuracy thereof. This offering is made subject to errors. Omissions, change of price or other conditions, prior sale or lease or withdrawal without notice. Prospective buyers/ tenants are encouraged to verify, independently, all pertinent data. The Mahoney Group, Inc. 3825 S. Florida Avenue, Suite 5, Lakeland, Florida 33813 is the agent of and represents the Owner/Landlord of this property.

# Maryoma Plaza

5615 South Florida Avenue, Lakeland, FL 33813

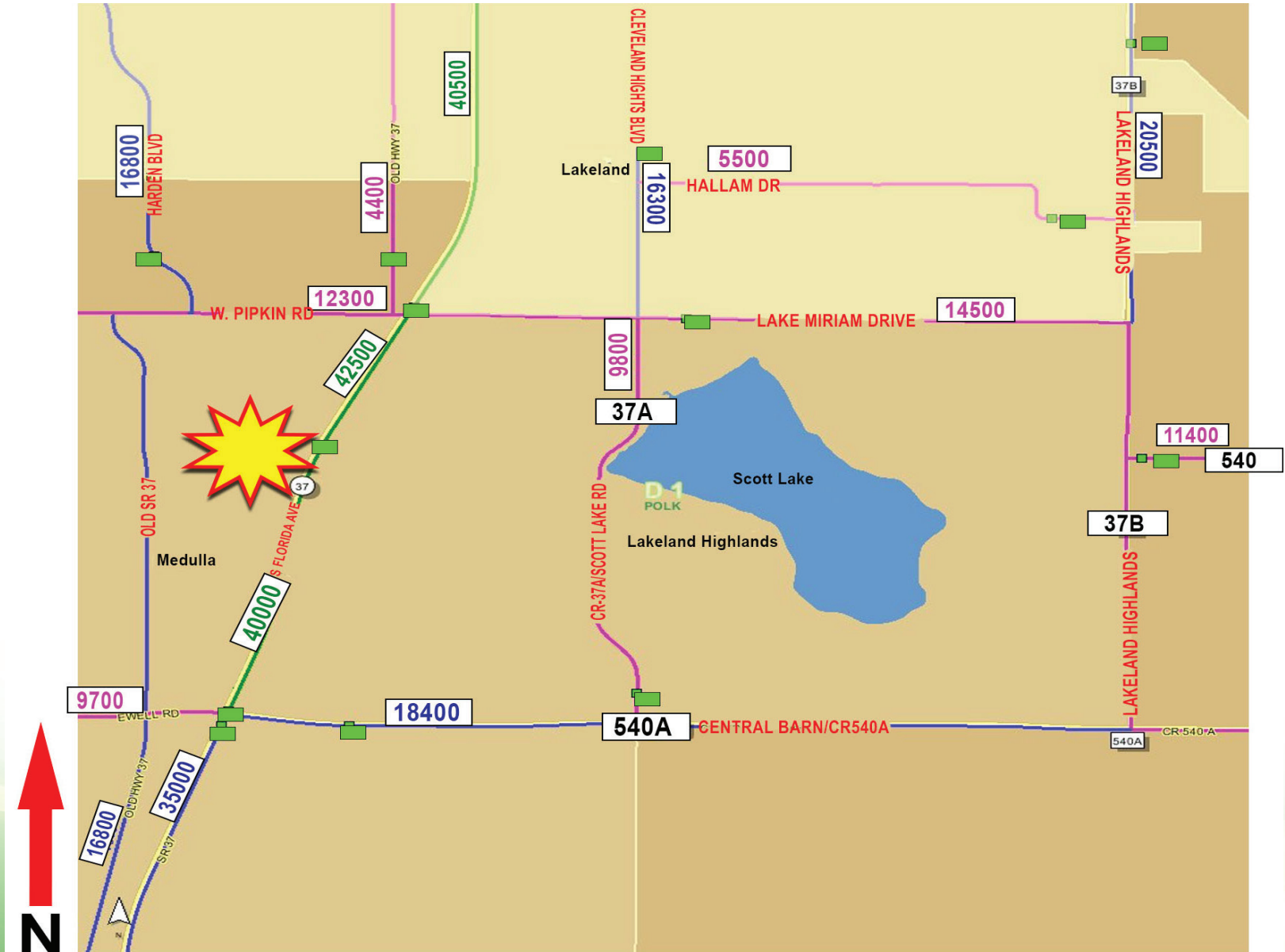

**5615 South Florida Ave. Lakeland, FL 33813**





# Maryoma Plaza

5615 South Florida Avenue, Lakeland, FL 33813

